

Lower Level Conference Areas

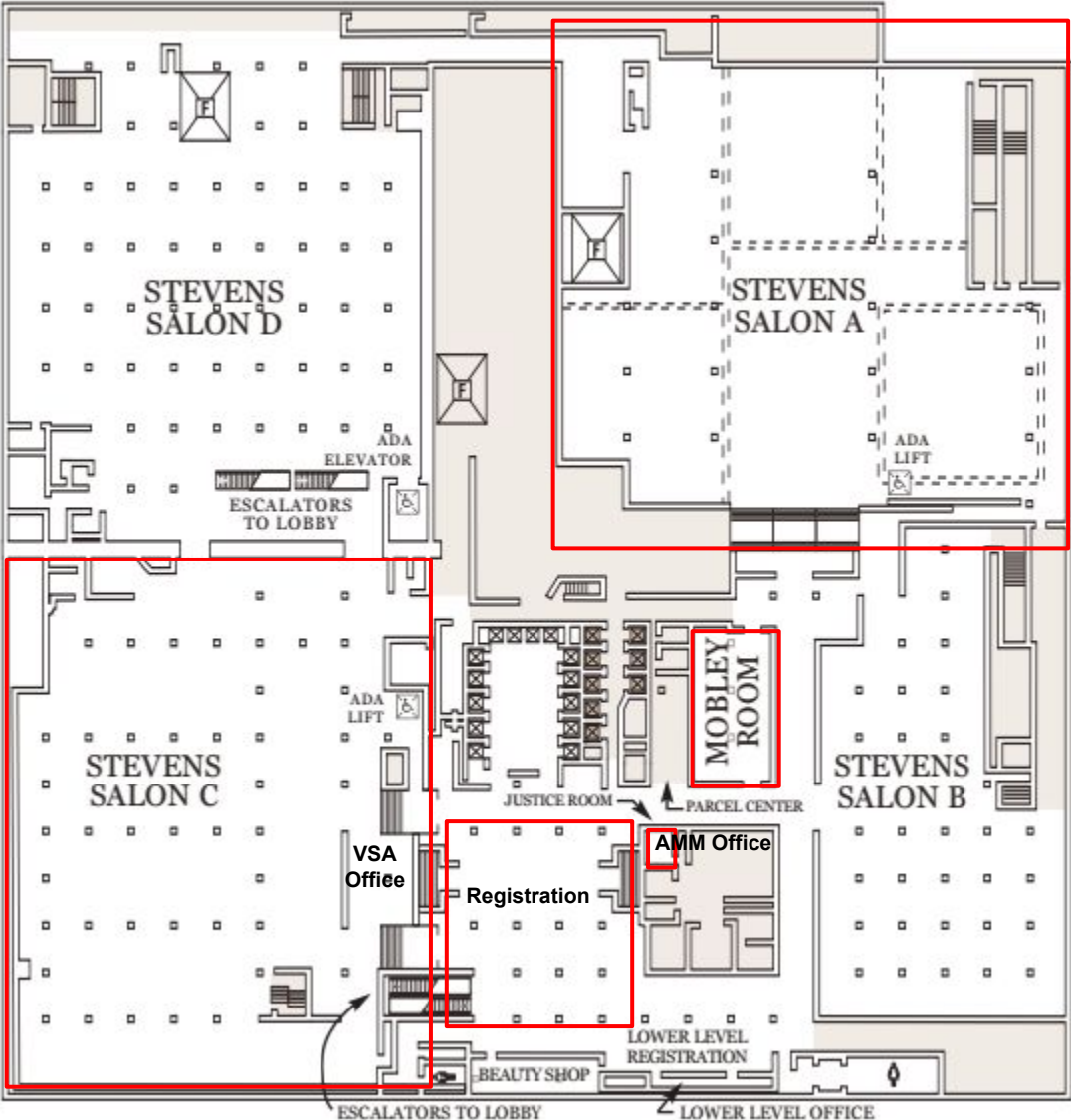
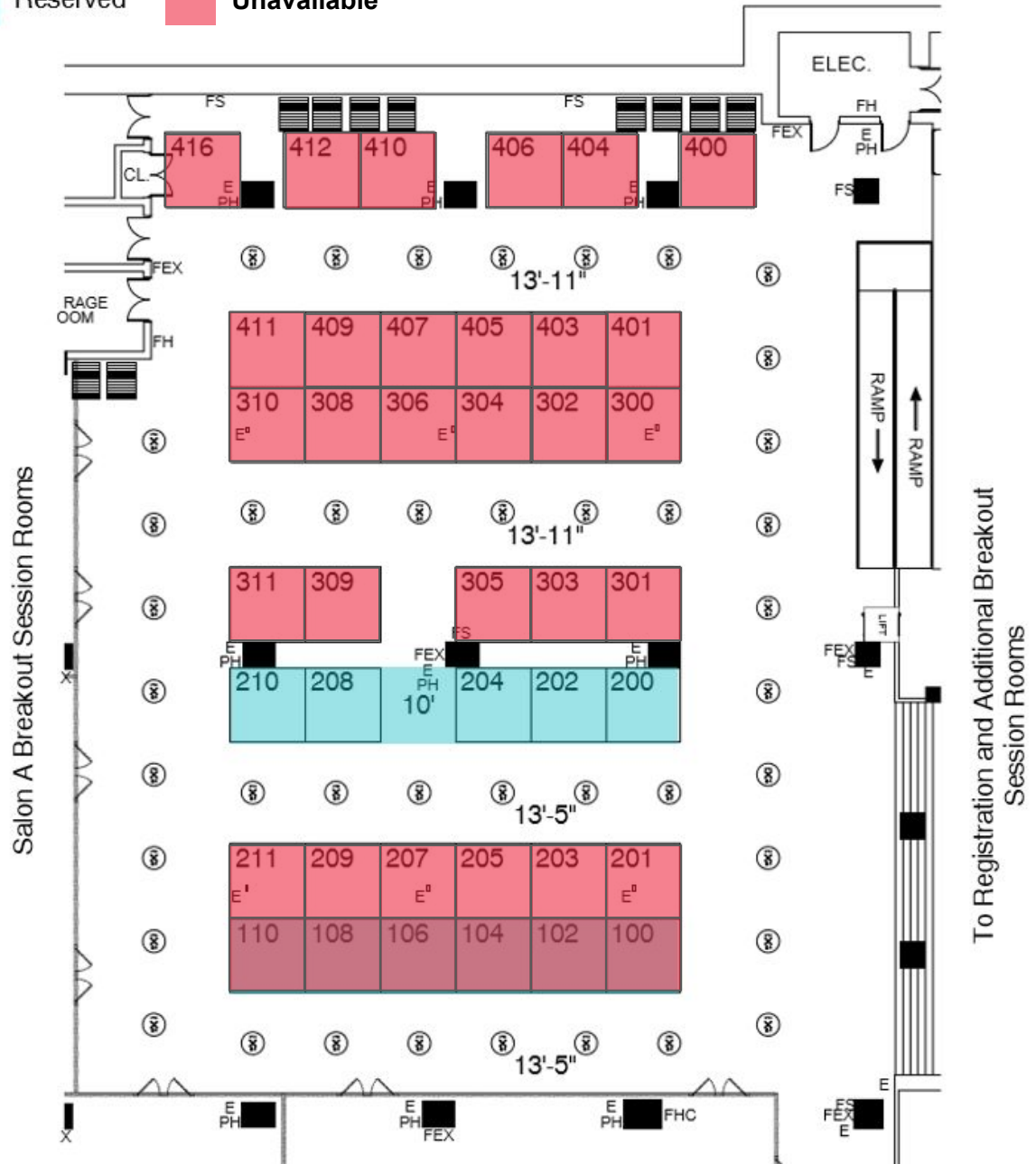

Exhibit Hall 1/ Salon A

100 - US Art Company	303 - The Field Museum
102 - Aon	304 - Cowan's Auctions
104 - Impact Comm.	305 - SAQA Global Exh
106/108 - TreeTowns Imaging	306 - Engberg Anderson
110 - OnCell	308 - Bluewater Studio
200 - VSA	309/311 - Belfry Historic
201 - NEDCC	310 - Dorfman
202 - VSA	400 - Arakawa
203 - McGough Const.	401 - MAAA/Exhibits USA
204 - VSA	403 - Tru Vue Inc.
205 - Gretel	404/406 - Teamworks Media
207 - Angle Park	405 - Science Museum MN
208 - VSA	407 - Piggyback App
209 - FORM	409 - AASLH
210 - VSA	410 - Minotaur Mazes
211 - Oertel Architects	411 - Museum Explorer
300 - Roto Studio	412 - Artemis Fine Art Serv.
301 - Solid Light	416 - Terry Dowd
302 - Museum Playbook	



To Registration and Additional Breakout Session Rooms

Exhibit Hall 2/ Salon C

Reserved
 Unavailable

↑ To Registration and Additional Breakout Session Rooms ↑



- 420 - VSA
- 421 - IMLS
- 422 - VSA
- 424 - VSA
- 426 - VSA
- 428 - VSA
- 520 - AMM
- 521 - Illinois Association
- 522 - USA, Inc.
- 523 -
- 620 - Powernet
- 621 - Kolbi Pipe Marker Co
- 622 -
- 720 -
- 721 -